



West Bend Joint School District #1

Referendum Projects Nov. 4, 2008

November 4 Referendum

What will be on the ballot is a two-question referendum which provides a comprehensive solution for district facility needs: enough space for all our students, better student security, handicap accessibility, and the elimination of half of our deferred maintenance needs.

Question 1 - \$41.4 million

- Construct new Jackson Elementary on a new, to-be-determined site
- Addition to Silverbrook Middle School
- Addition to Decorah Elementary
- Secure entrances at Green Tree, McLane, Fair Park, East and West High Schools
- Improved traffic flow and parking for McLane and Fair Park

Question 2 - \$27.4 million

- Addition to and remodeling of Badger Middle School

ELEMENTARY SCHOOLS

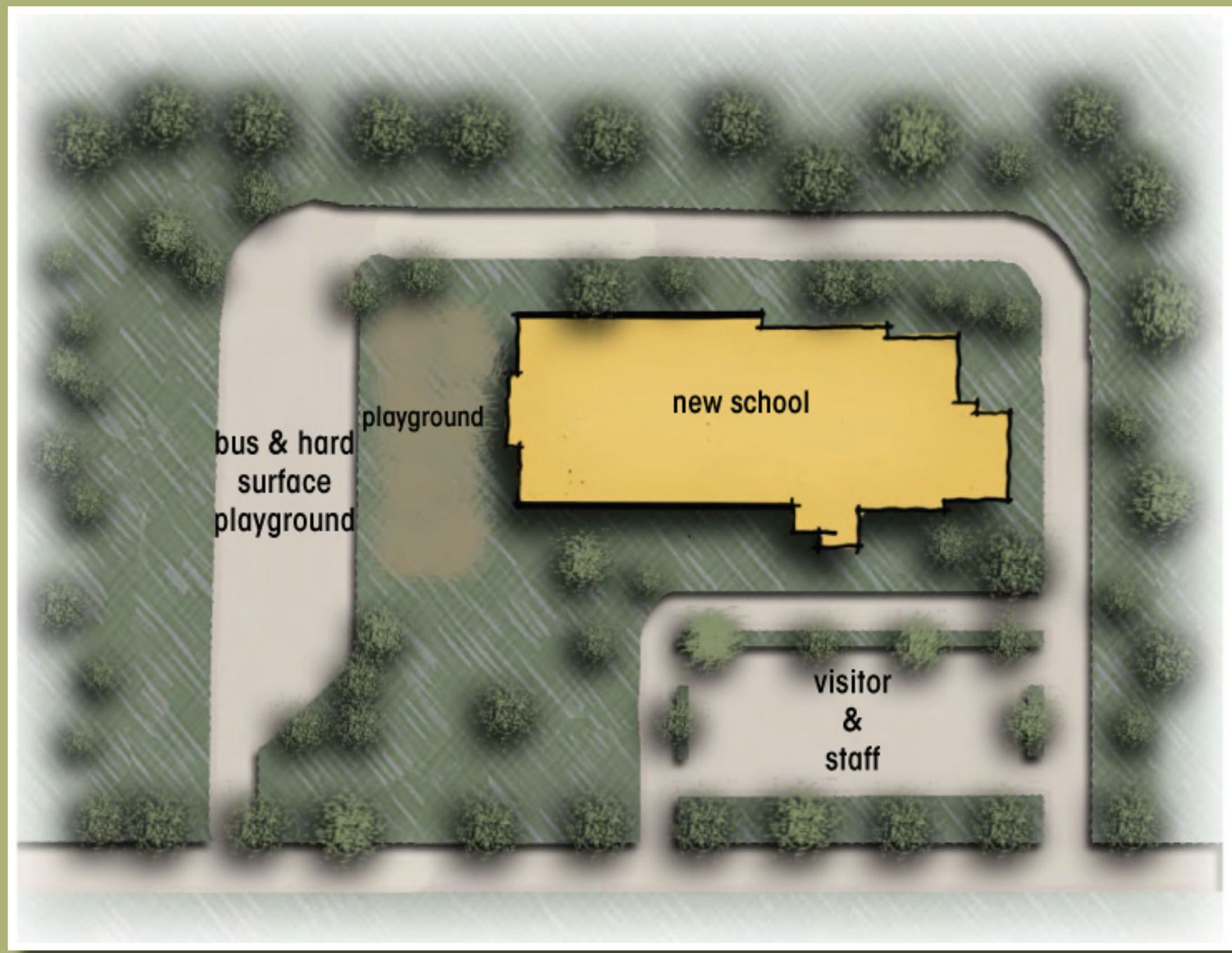

JACKSON

New 86,000 Sq Ft building on new site
(to be determined)
space for additional 140 students
removes \$8.5 million in deferred maintenance



DECORAH

31,000 Sq Ft addition
space for additional 190 students
removes \$1.1 million in deferred maintenance

GREEN TREE, FAIR PARK, McLANE

Safe/secure entrances; improved traffic flow and parking for McLane and Fair Park

MIDDLE SCHOOLS

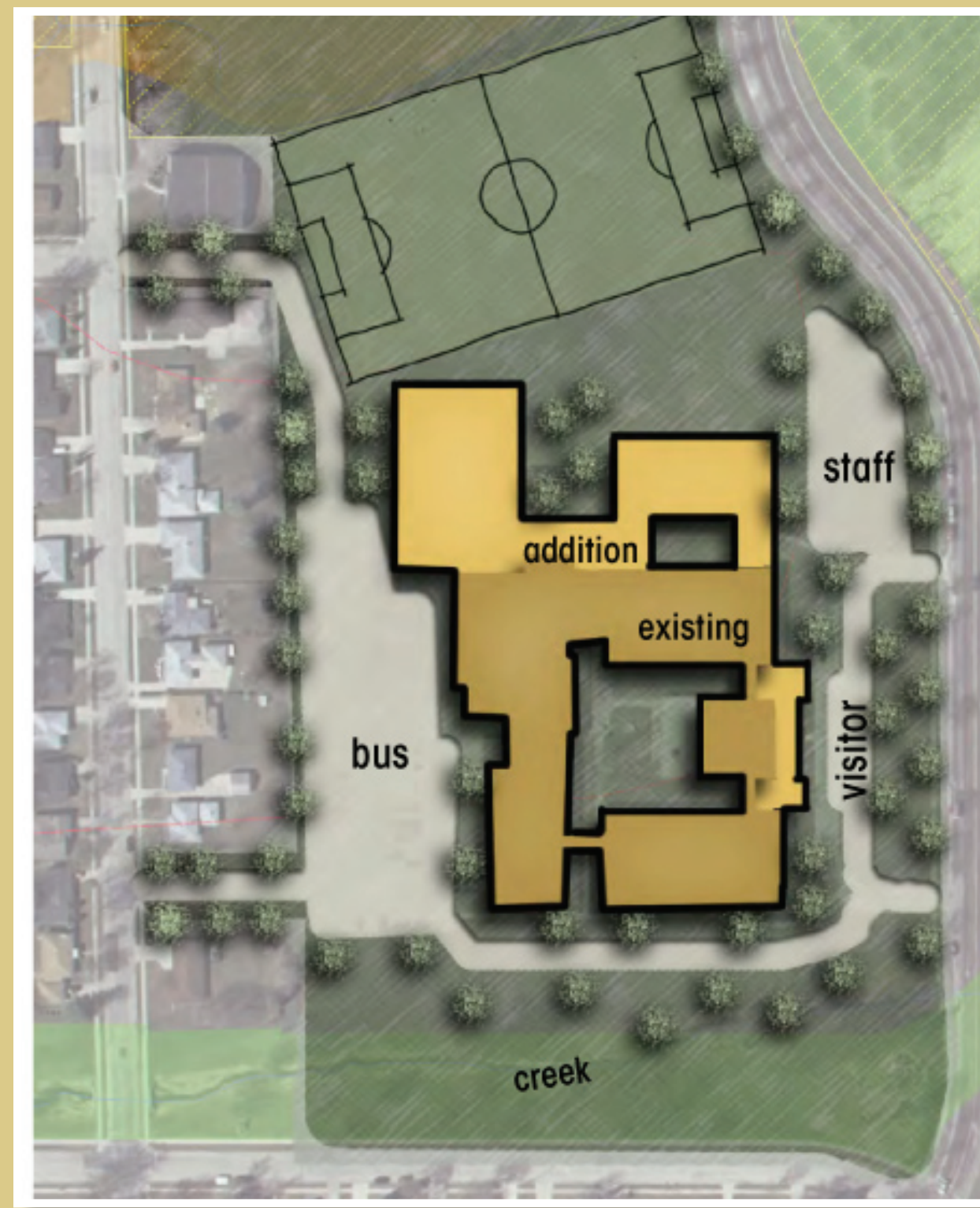

SILVERBROOK

- 56,000 Sq Ft addition
- space for additional 228 students
- equity in programming with Badger
- removes \$4.5 million in deferred maintenance



BADGER

- 120,000 Sq Ft addition
- removes oldest parts of building and keeps usable parts
- meets ADA compliance
- removes \$15.6 million in deferred maintenance

HIGH SCHOOLS

Safe/secure entrances

Visit our website for more facilities information:
www.west-bend.k12.wi.us